

Notes:

Traffic Flow:
 Eastbound: 6919 vehicles daily
 Westbound: 7945 vehicles daily

85th Percentile Speed:
 Eastbound: 25.9 mph
 Westbound: 27.2 mph

Key

- Proposed kerb
- Proposed carriageway surfacing
- Proposed raised table
- Proposed footway surfacing
- Proposed shared use area
- Proposed road marking
- Proposed verge
- Proposed bollard
- Proposed wayfinding sign

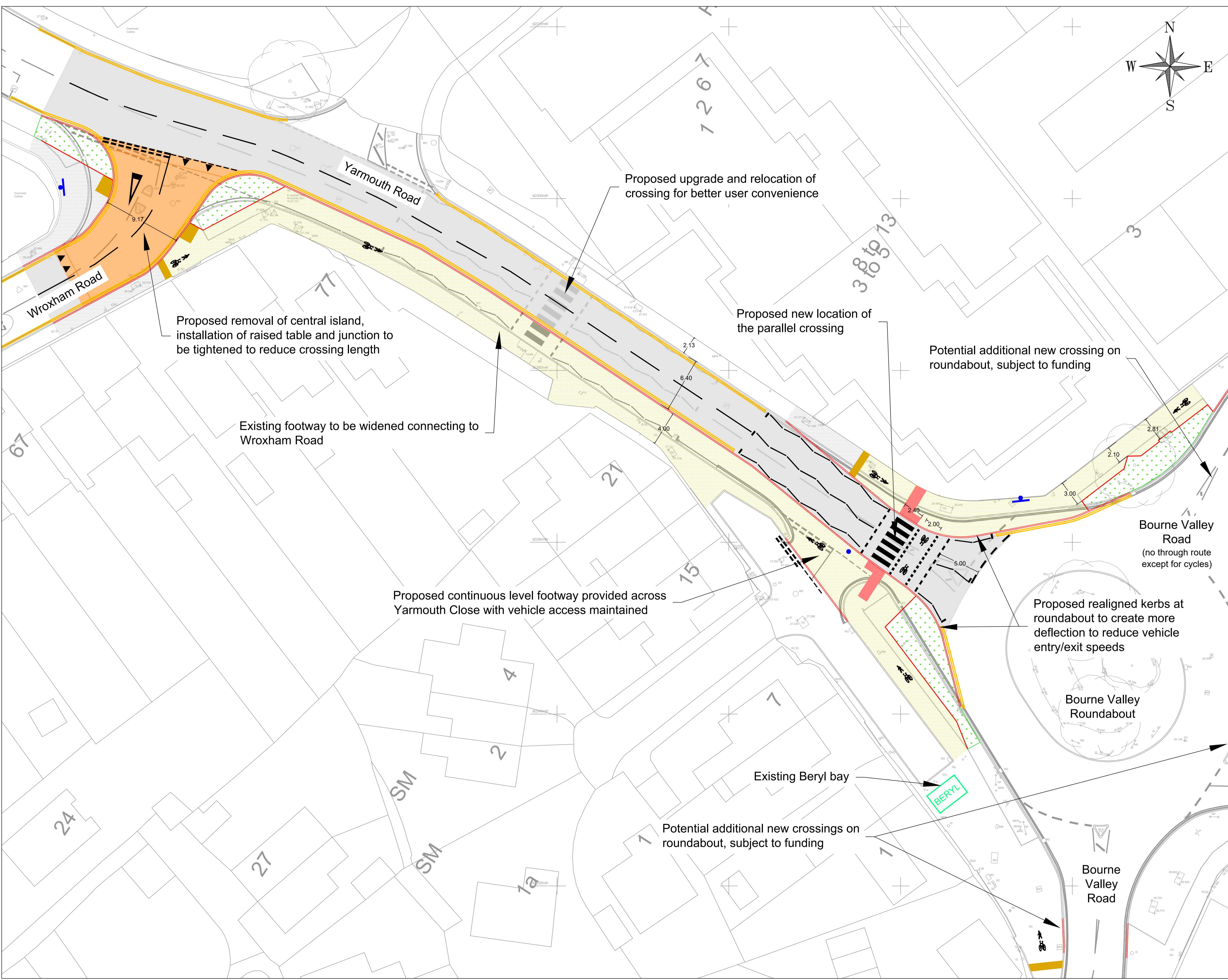

| Rev. | Date | Description |
|------|----------|-------------|
| P01 | 13/01/26 | First Issue |

Engineering

M.Raudsepp
 Service Director of
 Customer and Property



Project Title:
Active Travel Fund Improvements

Drawing Title:
**Consultation Plan
 Potential Changes for
 Yarmouth Road Crossing**

| | | |
|---|----------------------|-----------------|
| Drawn: CD | Checked: SH | Approved: SH |
| Date: 13/01/2026 | Scales: 1:200 @A1 | |
| Drawing Number: MU4515_H_P_0022_P_0111 | Rev: P01 | |